

Kutzky Sanitary Sewer Relief Line Project

**Jim Loehr, Project Manager
City of Rochester
Department of Public Works**

April 25, 2011

Overview

❖ **Introductions**

- Mike Wojcik, 2nd Ward Alderman
- Doug Nelson, Public Works re: I&I Study
- Mike Nigbur, Public Works re: Assessments

❖ **History**

❖ **Design Considerations**

❖ **Assessments**

❖ **Questions and Answers**

History

- ❖ Sewer backups in 2007
- ❖ Kutzky I&I Pilot Program
- ❖ Kutzky Sanitary Sewer Capacity
- ❖ 11th Avenue NW Siphon Capacity

Route Selection Considerations

- ❖ Sewer Elevations
- ❖ Length of Sewer Relief Line
- ❖ Siphon (capacity calculations)
- ❖ Sewer Relief Line Route Selected
 - 2nd St. NW (8th Ave. to 12th Ave.)
 - 8th Ave. NW (Civic Center Dr. to 2nd St.)

Sanitary Sewer Route



Design Considerations

- ❖ **Sanitary Sewer** (relief line, neighborhood)
- ❖ **Watermain** (4" & 6" diameter, age 1911-1924)
- ❖ **Sewer and Water Service Connections**
- ❖ **Roadway** (parking, lane width, bump outs)
- ❖ **Utilities**
- ❖ **Traffic/Access**

Roadway Cross Section

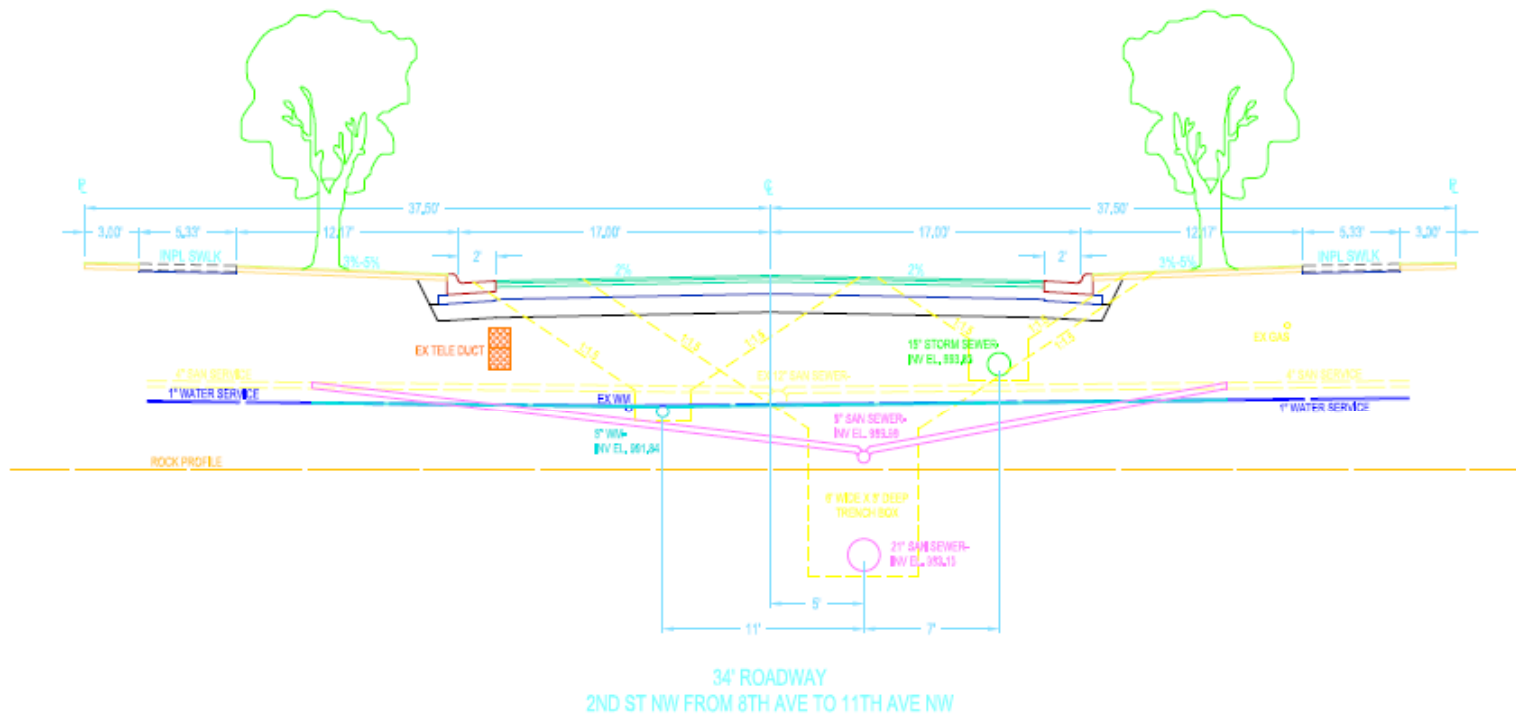

Roadway Cross Section

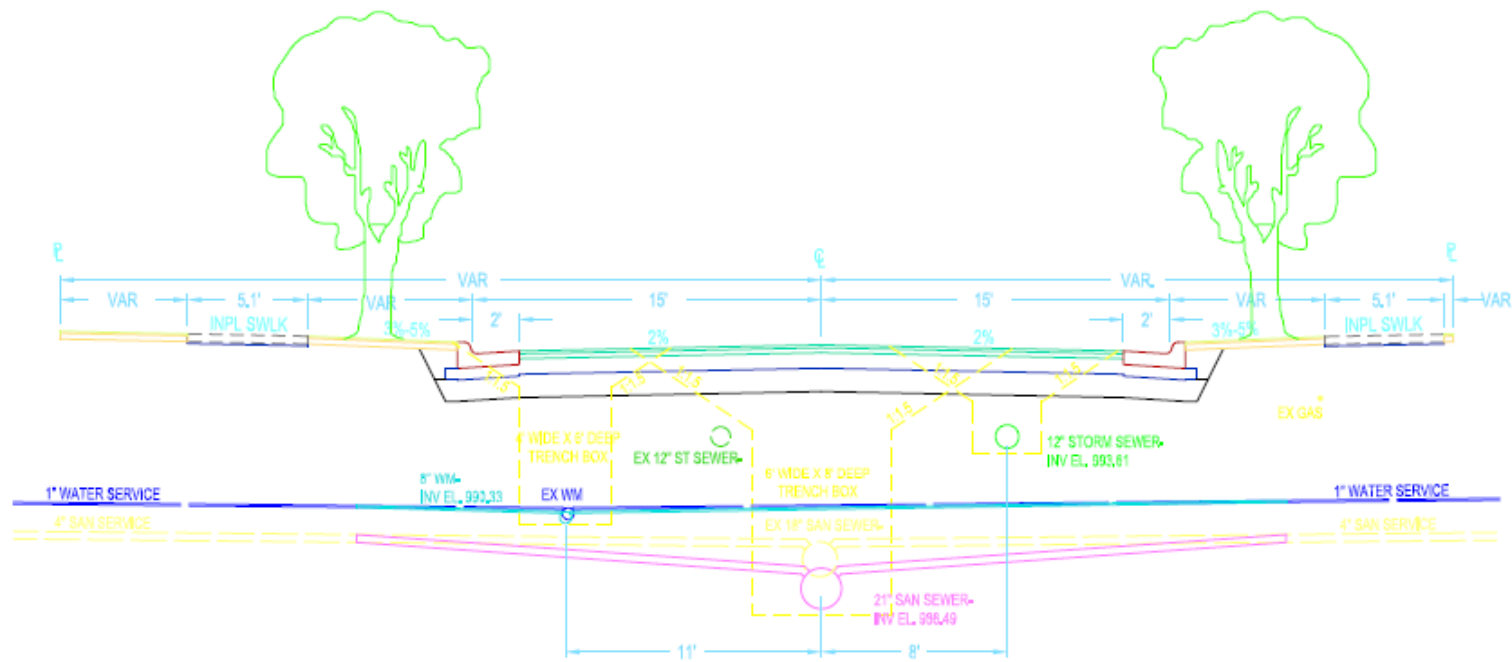

30' ROADWAY
2ND ST NW FROM 11TH AVE TO 12TH AVE NW
8TH AVE NW FROM CIVIC CENTER DR TO 2ND ST NW

Tentative 8th Ave. Lay Out

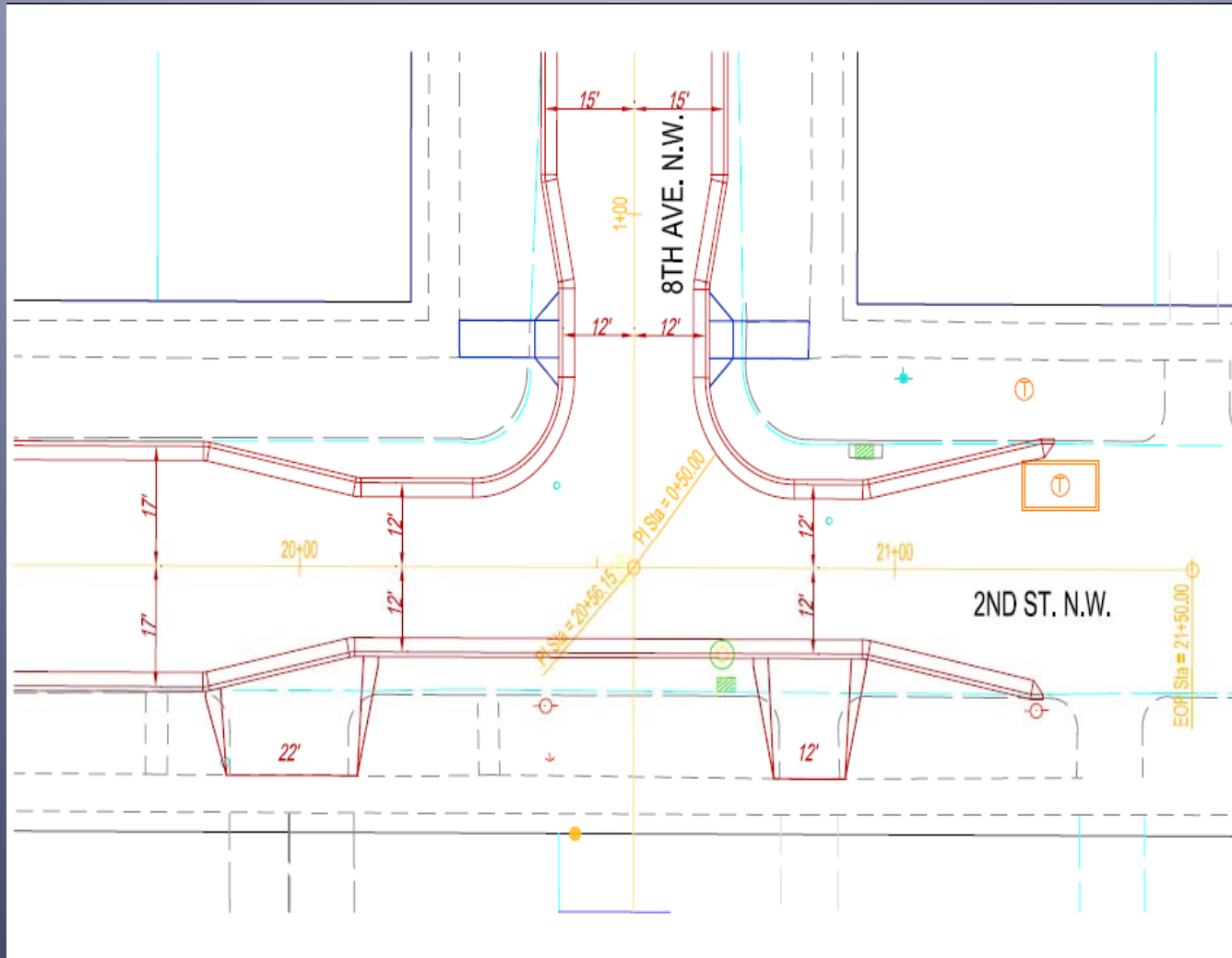

Tentative 8-1/2 Ave. Lay Out

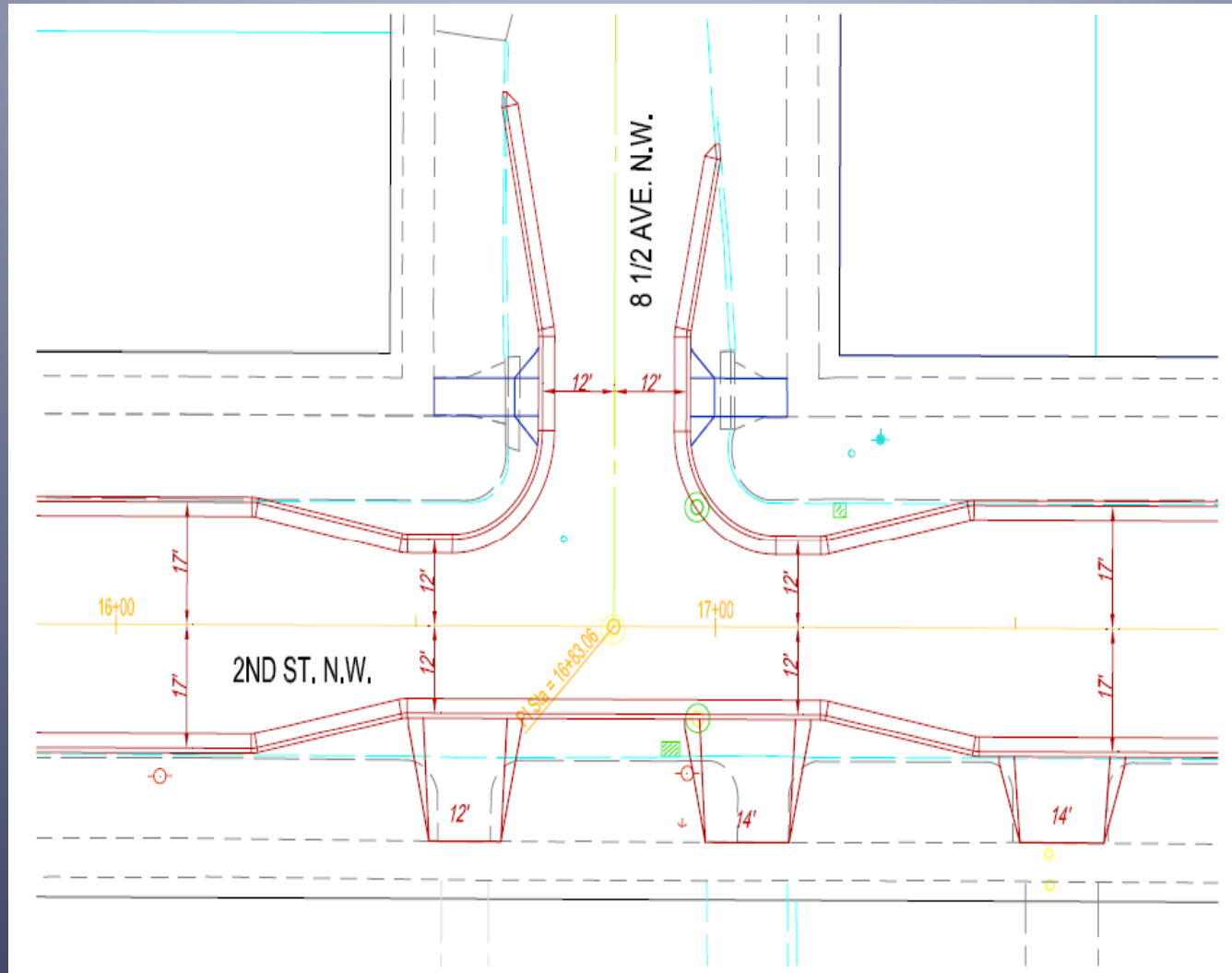

Tentative 9th Ave. Layout

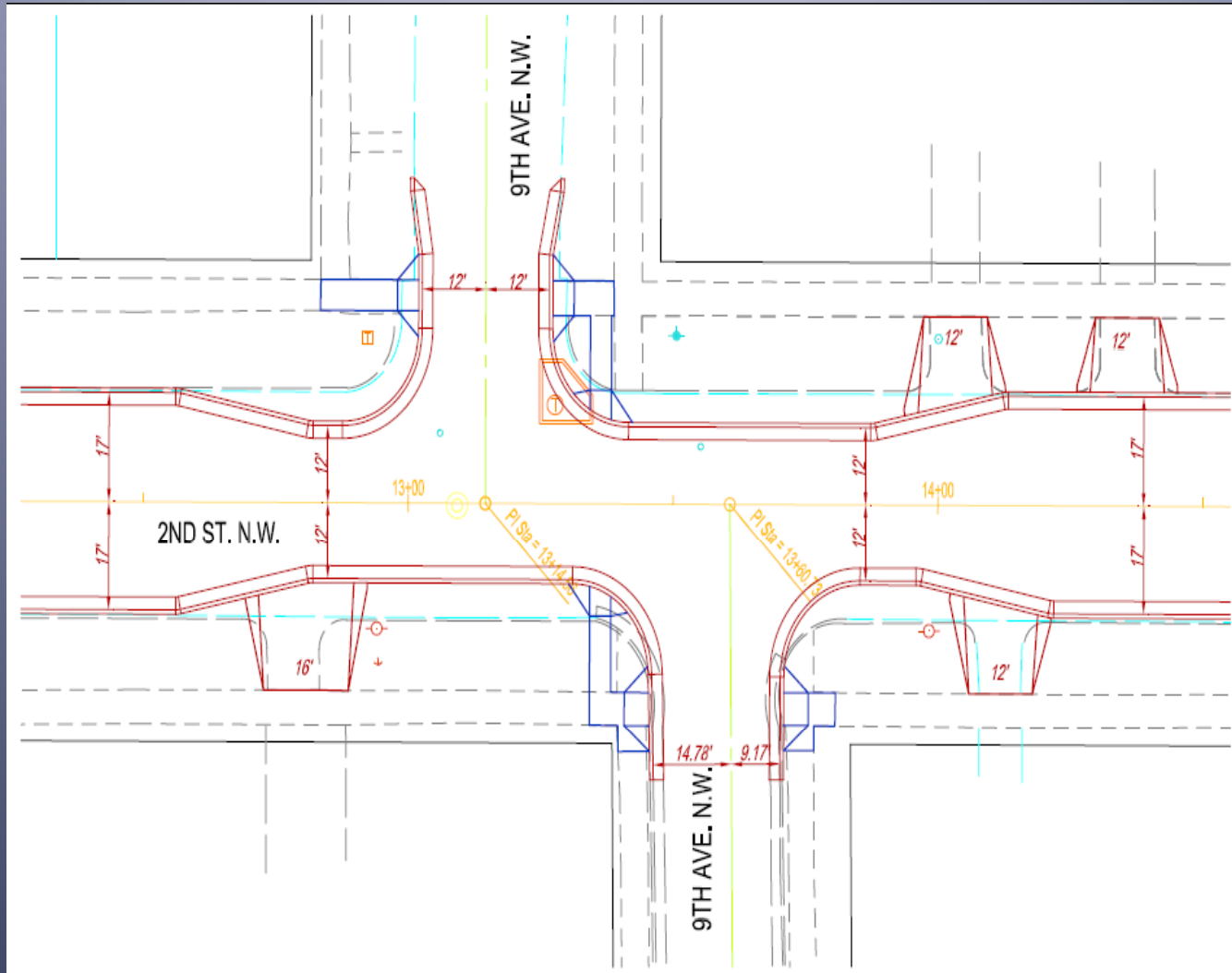

Tentative 11th Ave. Lay Out

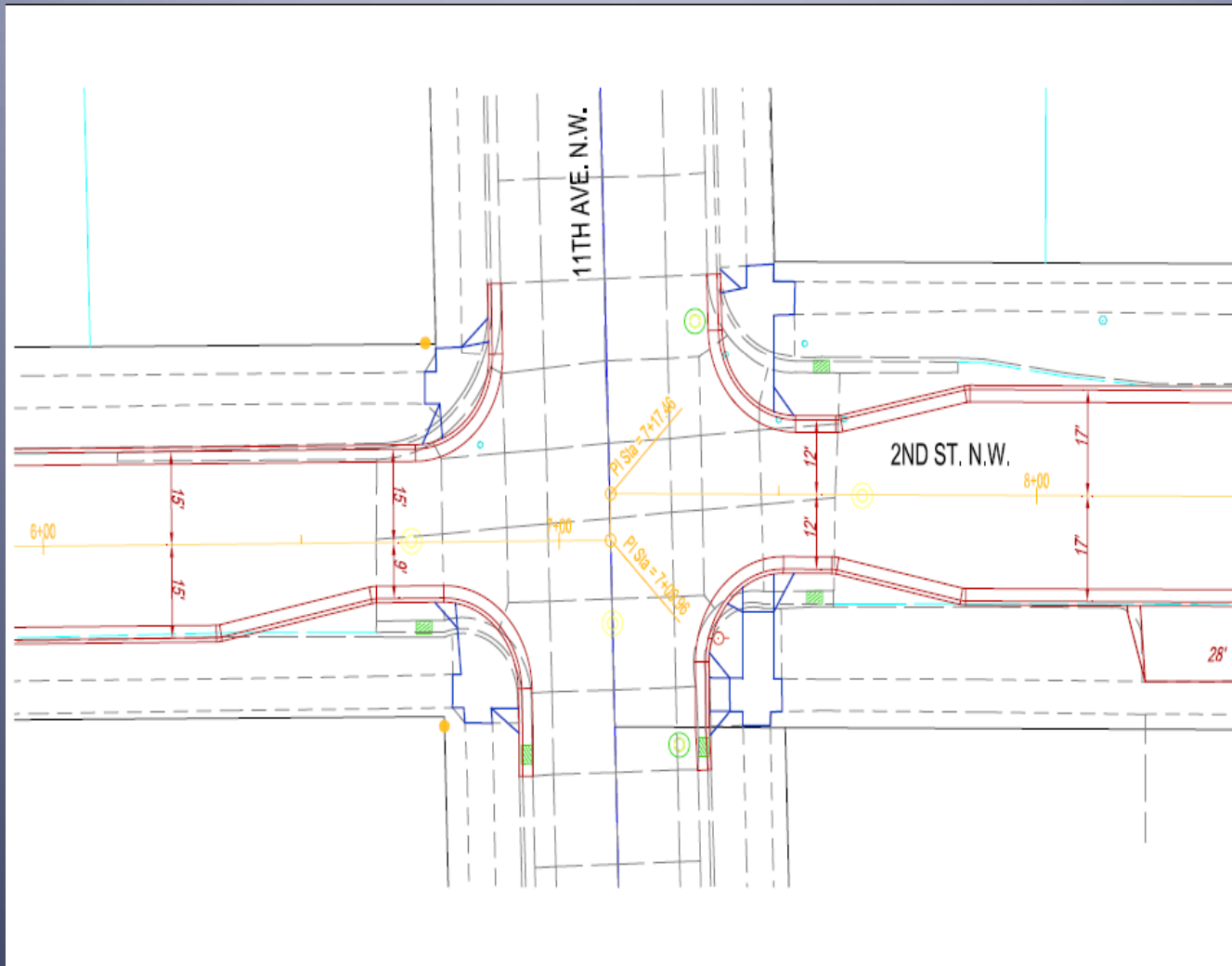

Tentative 12th Ave. Lay Out

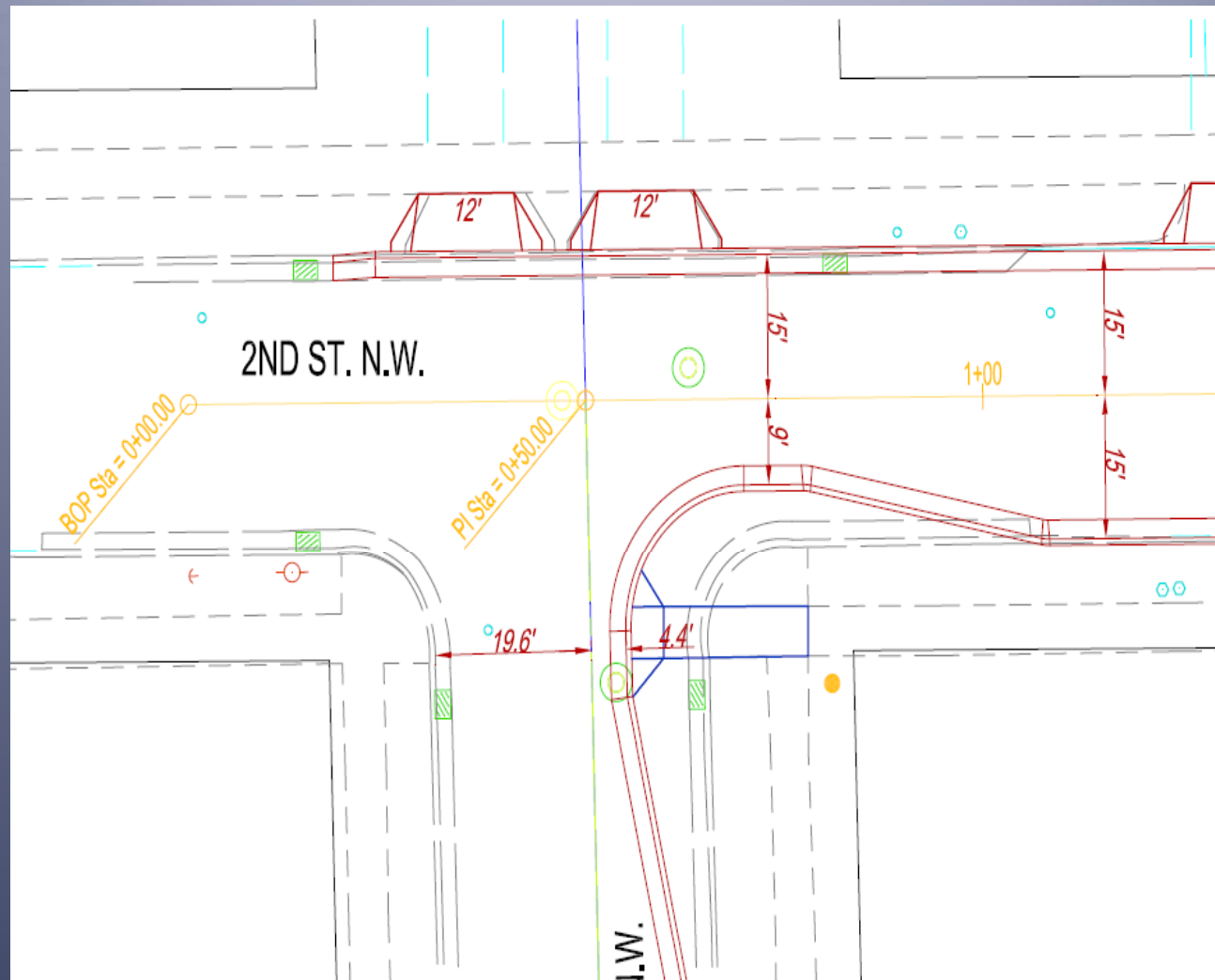

Assessments for a Typical Kutzky Residential Property

Street Reconstruction	60 ft @ \$87.80/ft	\$5,268
Water Service Replacement	New 1" Svc from main to boulevard	\$1,253
Sewer Service Replacement	New 4" Svc from main to boulevard	\$1,253
Typical Assessment for 60 Foot Frontage		\$7,774

Proposed Assessments for a Kutzky Residential Property

Street Reconstruction	Per Lot Charge	\$1,800
Water Service Replacement	New 1" Svc from main to boulevard	\$ -0-
Sewer Service Replacement	New 4" Svc from main to boulevard	\$ -0-
Proposed Per Lot Project Assessment		\$1,800

Estimated Project Cost

❖ Assessments	\$ 196,200
❖ RPU (watermain replacement)	\$ 250,000
❖ <u>Sewer Utility</u>	<u>\$1,653,800</u>
❖ Total Estimated Project Cost	\$2,100,000

What's Next?

- ❖ **Complete Plans & Specifications**
- ❖ **Determine Final Assessments**
- ❖ **Conduct Project Hearing**
- ❖ **Conduct Assessment Hearing**
- ❖ **Advertise for Bids & Award Contract**
- ❖ **Construct Project** 2011 or 2012????

Questions and Answers

Thank You!

Contact Information:

**Jim Loehr, 328-2419 or
jloehr@rochestermn.gov**