

### 500 ft. Notification Area of

Conditional Use Permit - Incentive Development Preliminary Plan #2018-001CUP by Bloom Holding c/o Oxford Management, for a mixed-use development consisting of residential, transient accommodations, retail, and restaurant uses. The property is located between 2nd Street and 4th Street SE, to the west of the Zumbro River.

**City Council Ward:  
4 - Mark Bilderback**

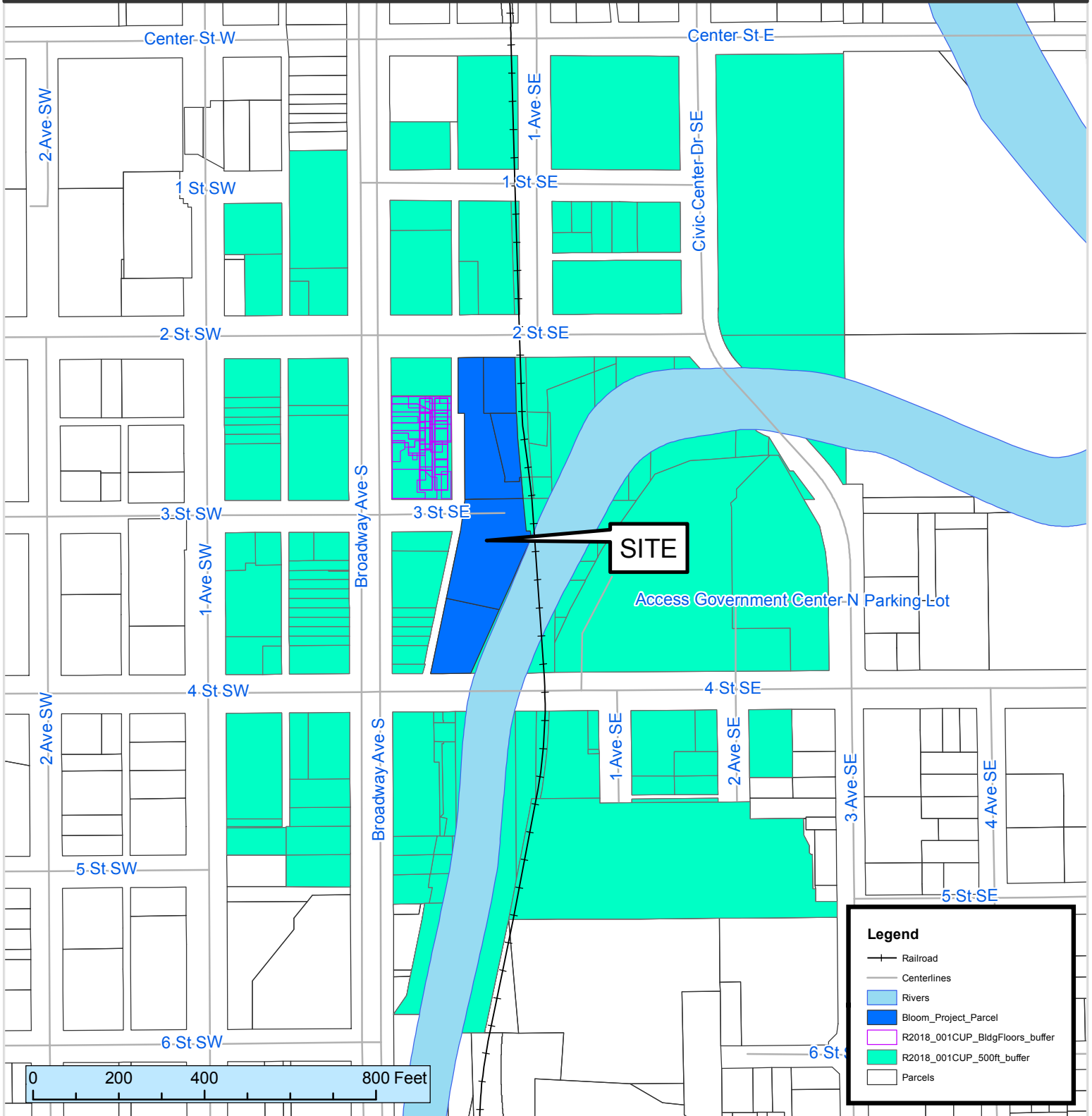

This map prepared by the GIS Division, Rochester-Olmsted County Planning Department. Olmsted County is not responsible for omissions or errors contained herein. If discrepancies are found within this map, please notify the GIS Division, Rochester-Olmsted County Planning Department, 2122 Campus Drive SE Rochester MN 55904 (507) 328-7100.

Map Date: 01/17/2018

