

### 500 ft. Notification Area of

Amendment to General Development Plan #R00303GDP by 2nd Street Parking, LLC for a temporary surface parking lot on a 1.28 acre site located at the northeast corner of the intersection of 2nd Street SW and 13th Avenue SW.

City Council Ward: 2 - Michael Wojcik

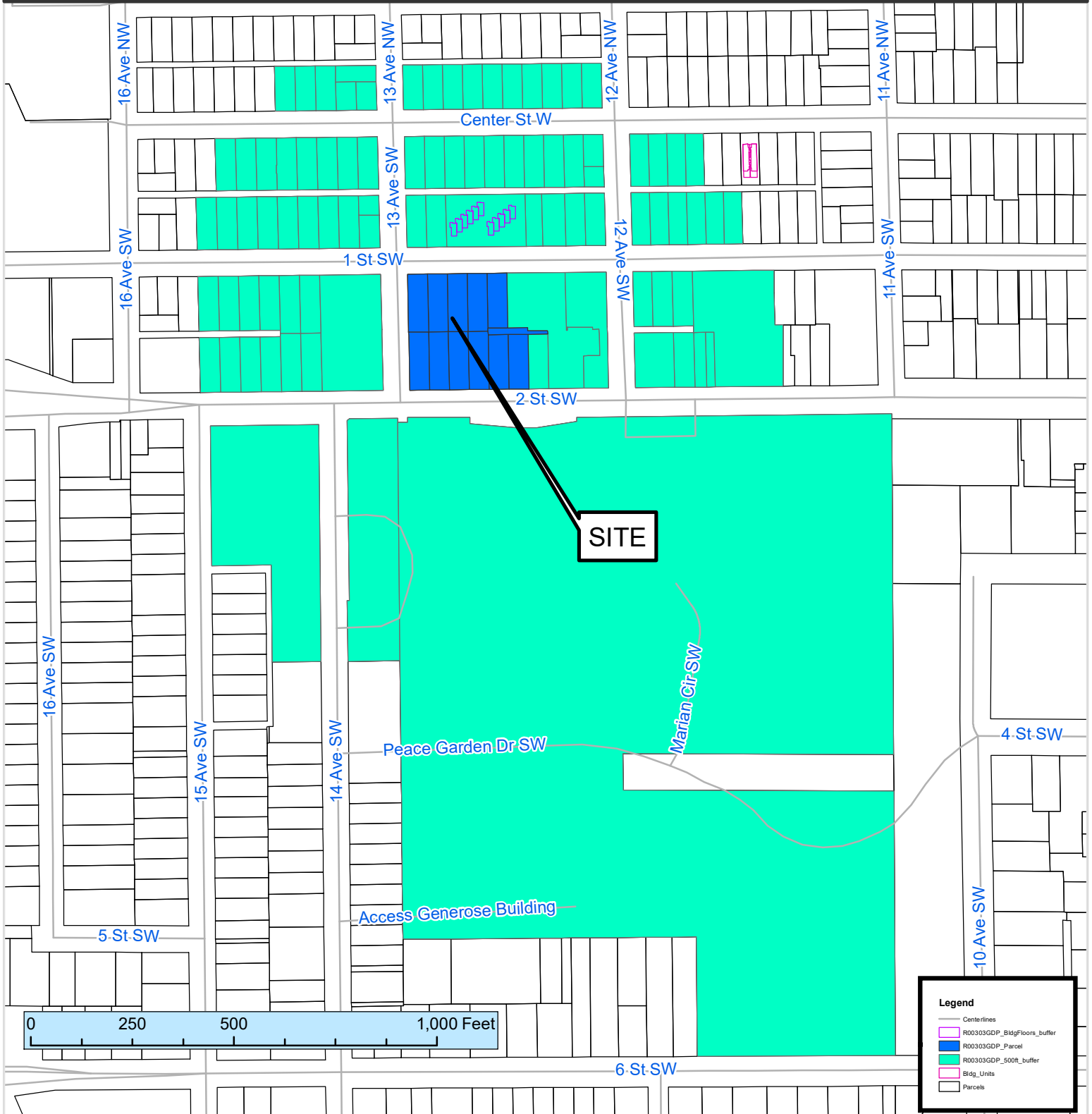

This map prepared by the GIS Division, Rochester-Olmsted County Planning Department. Olmsted County is not responsible for omissions or errors contained herein. If discrepancies are found within this map, please notify the GIS Division, Rochester-Olmsted County Planning Department, 2122 Campus Drive SE Rochester MN 55904 (507) 328-7100.

Map Date: 10/04/2018

