

500 ft. Notification Area of

Conditional Use Restricted Development Final Plan #R2018-029CUP by EKN Development Group for a five-floor retail and hotel building. The site is 1.16 acres in size and is located on the northwest corner of the intersection of 2nd Street SW and 11th Avenue SW.

City Council Ward: 2 - Michael Wojcik

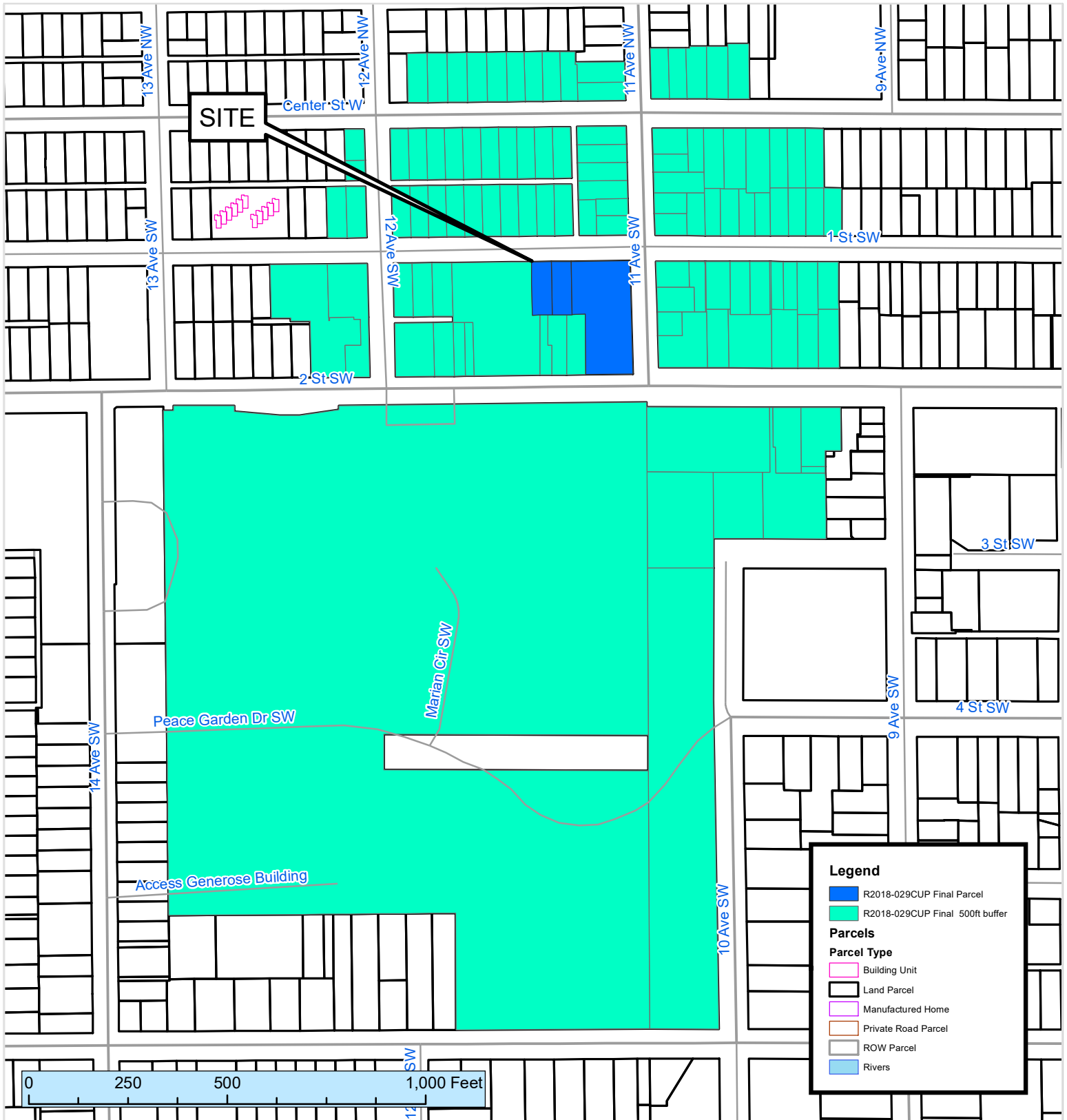

This map prepared by the GIS Division, Rochester-Olmsted County Planning Department. Olmsted County is not responsible for omissions or errors contained herein. If discrepancies are found within this map, please notify the GIS Division, Rochester-Olmsted County Planning Department, 2122 Campus Drive SE Rochester MN 55904 (507) 328-7100.

Map Date: 04/02/2019

