

### 500 ft. Notification Area of

Conditional Use Permit - Incentive Development Final Plan #R2019-003CUP by North Rock Real Estate, for a six-story transient accommodation use (hotel) with two levels of underground parking. The site is 0.42 acres in size and is located on the northwest corner of the intersection of 6th Avenue SW and 2nd Street SW.

**City Council Ward: 2 - Michael Wojcik**

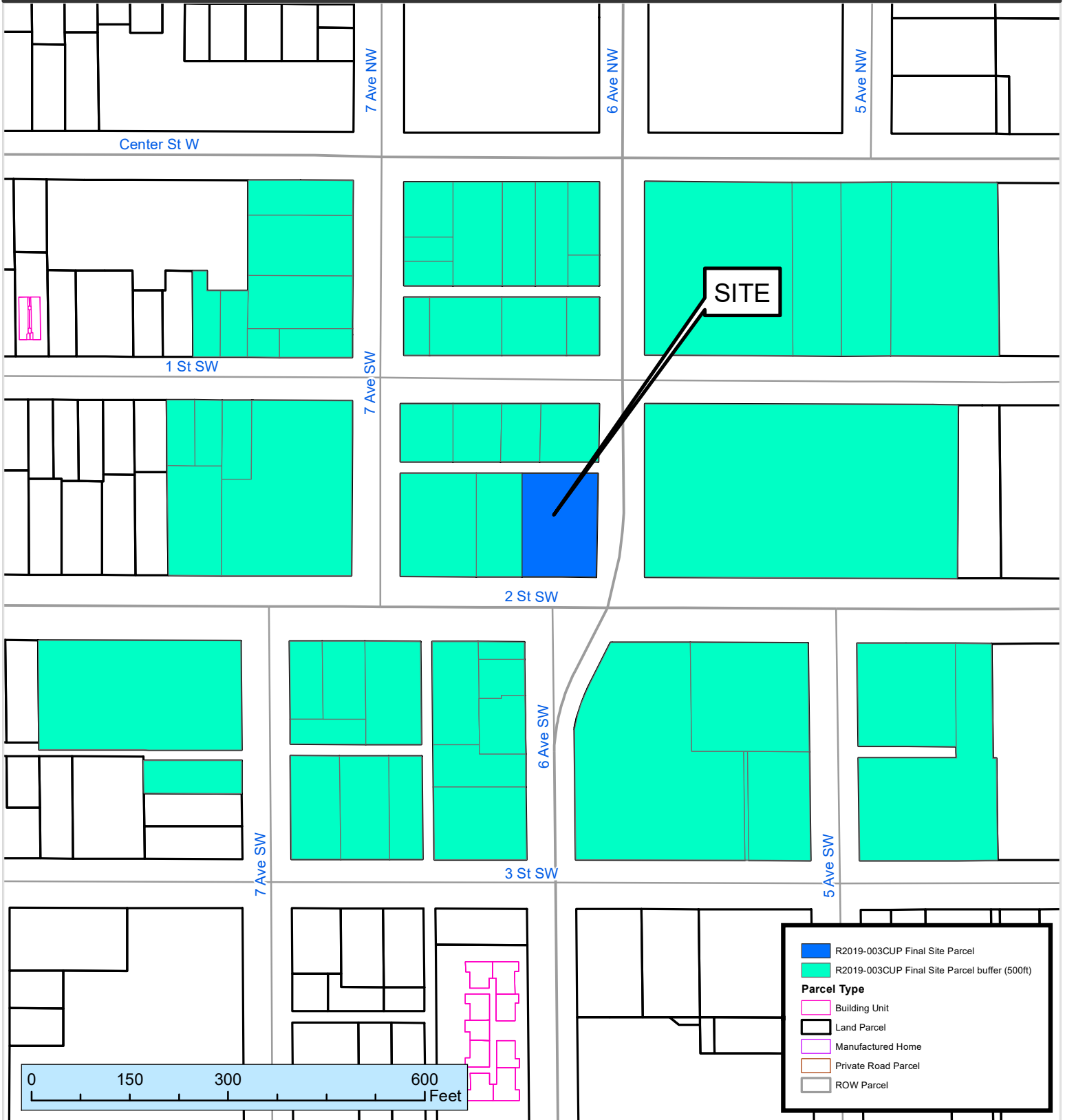

This map prepared by the GIS Division, Rochester-Olmsted County Planning Department. Olmsted County is not responsible for omissions or errors contained herein. If discrepancies are found within this map, please notify the GIS Division, Rochester-Olmsted County Planning Department, 2122 Campus Drive SE Rochester MN 55904 (507) 328-7100.

Map Date:  
04/25/2019

