

# 500 ft. Notification Area of

Final Plat #R2019-005PLAT by EKN Development Group, to be known as RHP Hotel Subdivision. The final plat would consolidate the 1.16 acre area containing 3 lots into one lot. The site is located north of 2nd Street SW and west of 11th Avenue SW.

City Council Ward: 2 - Micahel Wojcik

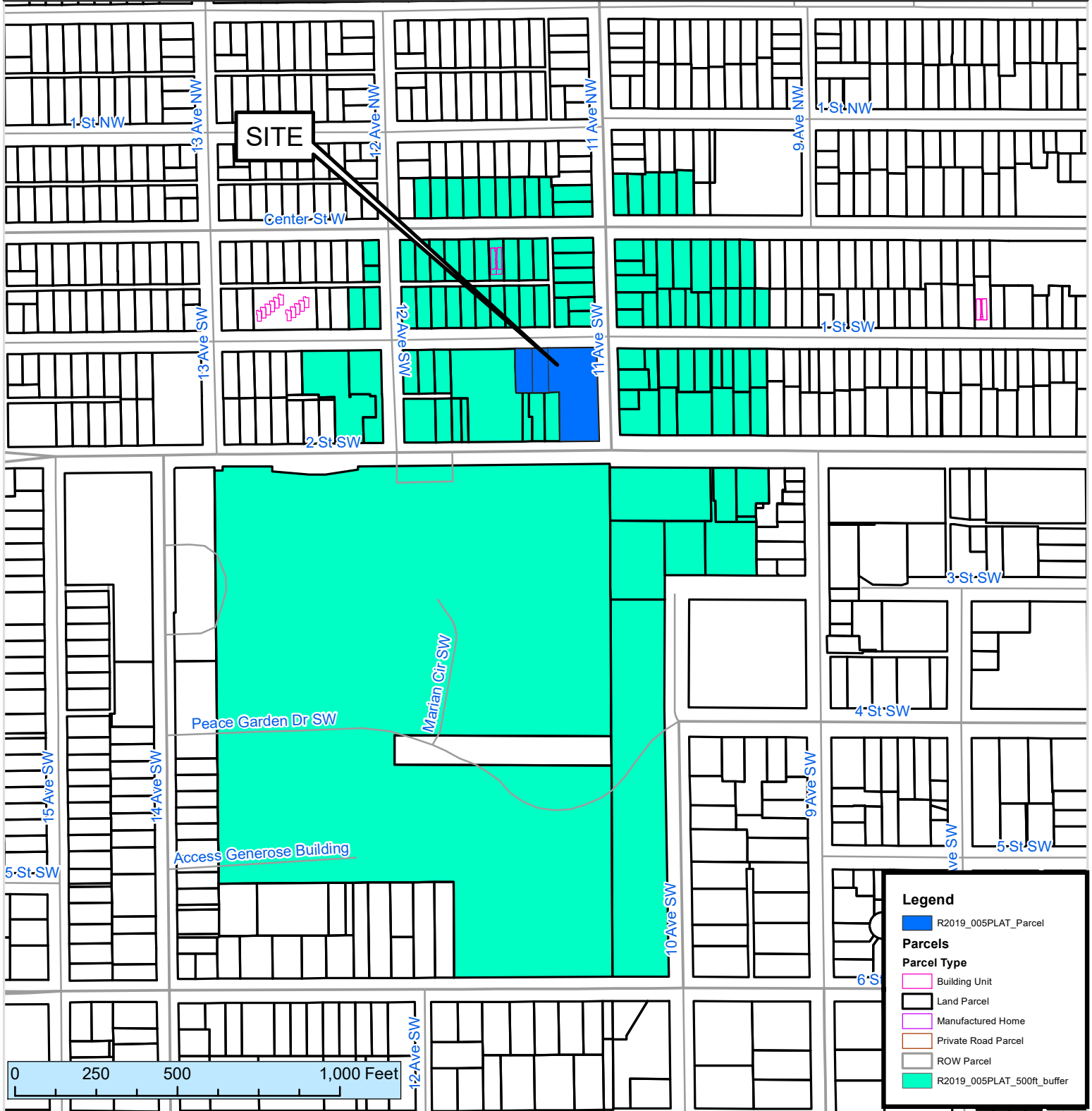

This map prepared by the GIS Division, Rochester-Olmsted County Planning Department. Olmsted County is not responsible for omissions or errors contained herein. If discrepancies are found within this map, please notify the GIS Division, Rochester-Olmsted County Planning Department, 2122 Campus Drive SE Rochester MN 55904 (507) 328-7100.

Map Date: 04/24/2019

