

### 500 ft. Notification Area of

Conditional Use Permit - Incentive Development Preliminary Plan #CD2019-005CUP by Storm Properties LLC, for a six-story transient accommodation use (hotel) with surface and underground parking. The site is .67 acres in size and located on the northwest corner of the intersection of 5th Ave NW and 2nd Street NW.

**City Council Ward: 4 - Mark Bilderback**

**City Council Ward: 2 - Mike Wojcik**

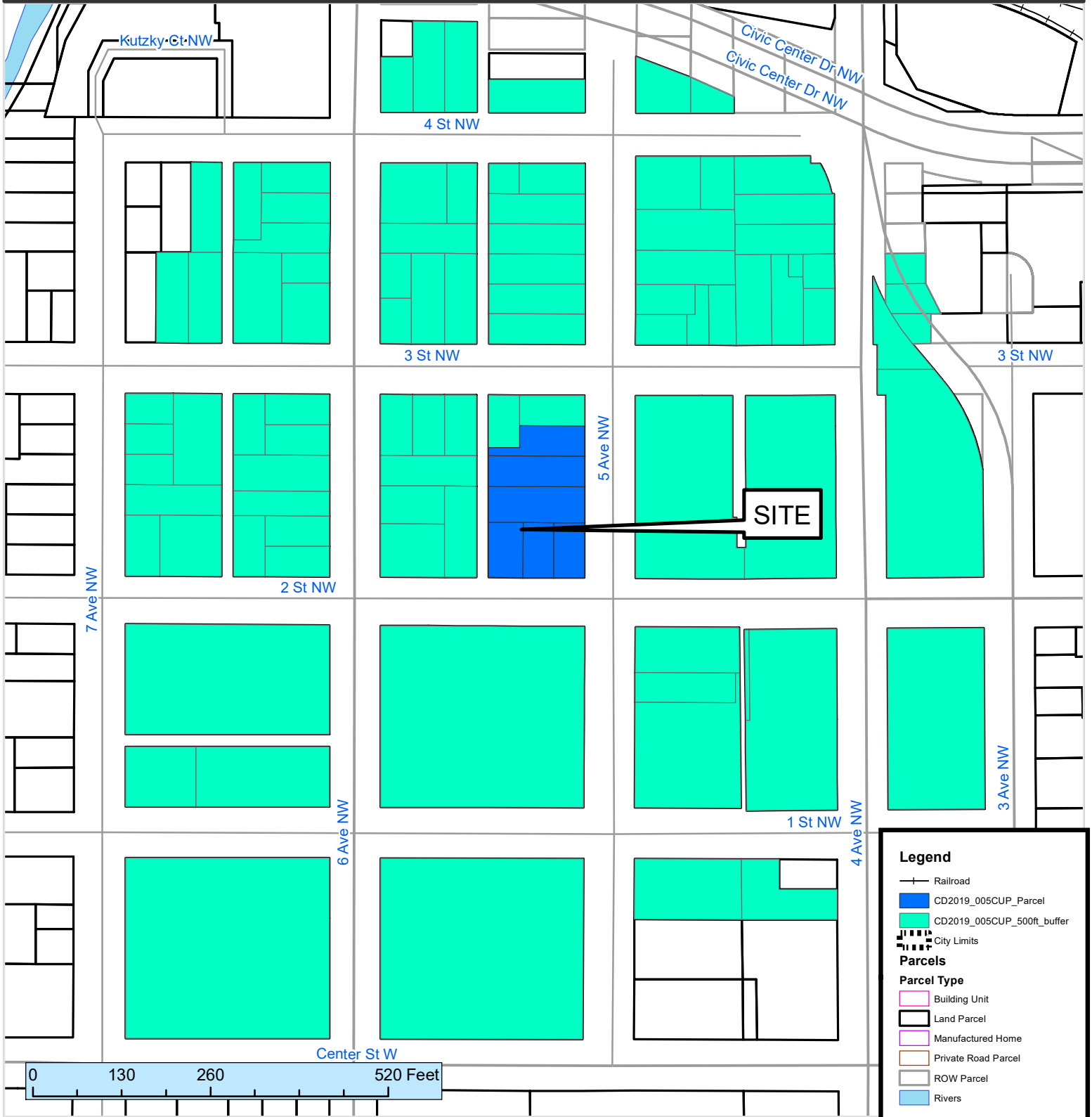

This map prepared by the GIS Division, Rochester-Olmsted County Planning Department. Olmsted County is not responsible for omissions or errors contained herein. If discrepancies are found within this map, please notify the GIS Division, Rochester-Olmsted County Planning Department, 2122 Campus Drive SE Rochester MN 55904 (507) 328-7100.

Map Date: 09/04/2019

