

550 ft. Notification Area of

General Development Plan #CD2019-003GDP by Franklin Kottscade, to be known as Willow Creek Commons. The General Development Plan is 14.79 acres in size and consists of 50 attached single family-units. The site is located on the east side of 11th Avenue SW, south of 40th Street SW, and north of Willow Creek.

City Council Ward: 1 - Patrick Keane

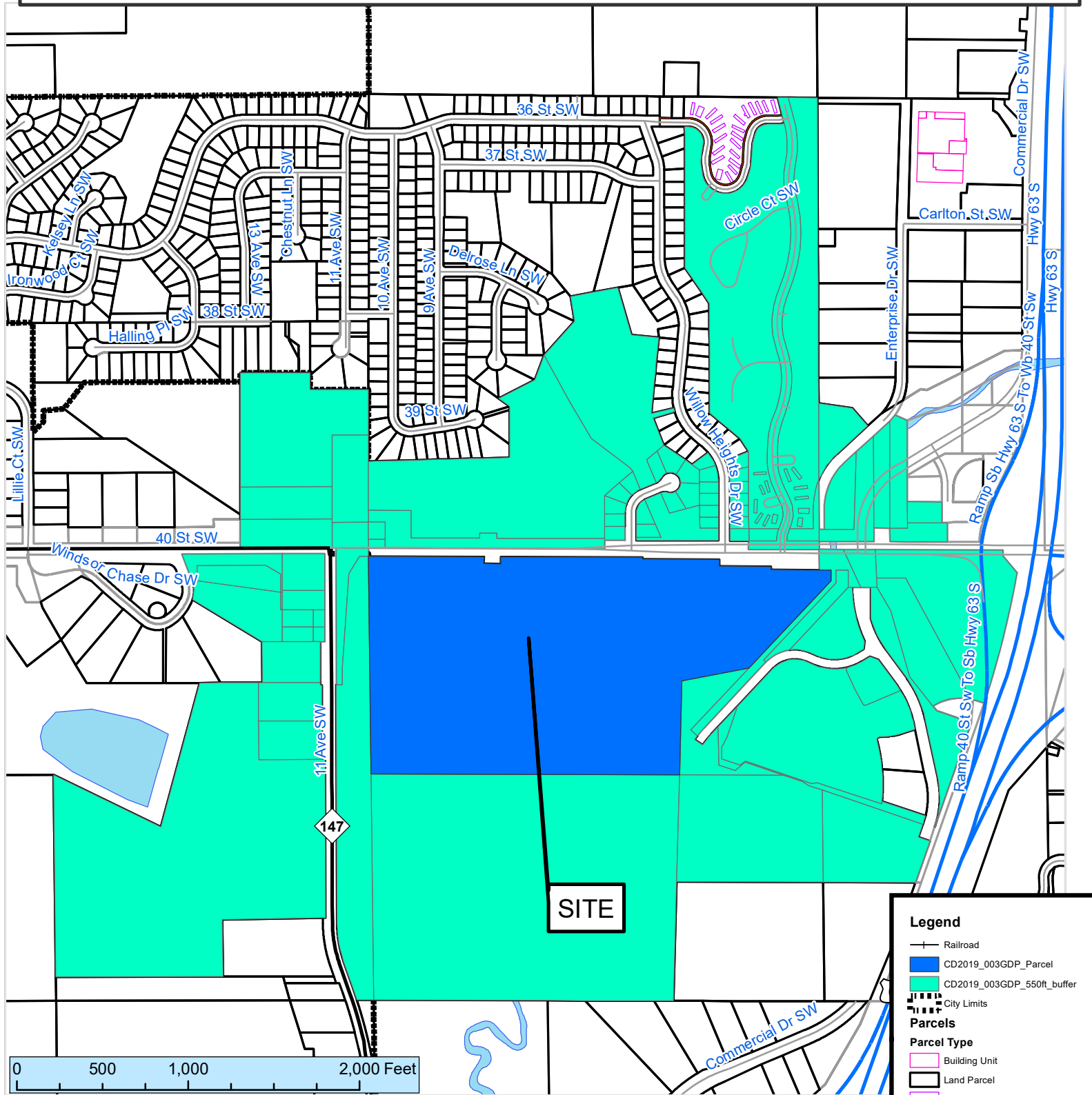

This map prepared by the GIS Division, Rochester-Olmsted County Planning Department. Olmsted County is not responsible for omissions or errors contained herein. If discrepancies are found within this map, please notify the GIS Division, Rochester-Olmsted County Planning Department, 2122 Campus Drive SE Rochester MN 55904 (507) 328-7100.

Map Date: 11/19/2019