

CITY OF ROCHESTER, MN

ALTERNATE SIDE WINTER PARKING PILOT PROGRAM

This pamphlet contains information on the City's Alternate Side Winter Parking Pilot Program (December 1 to March 1) in the Eastside Neighborhood.



Contact:

Traffic & Parking Operations
Department of Public Works
507-328-2430 or
sbudzyna@rochestermn.gov



ALTERNATE SIDE WINTER PARKING PILOT PROGRAM NEIGHBORHOOD

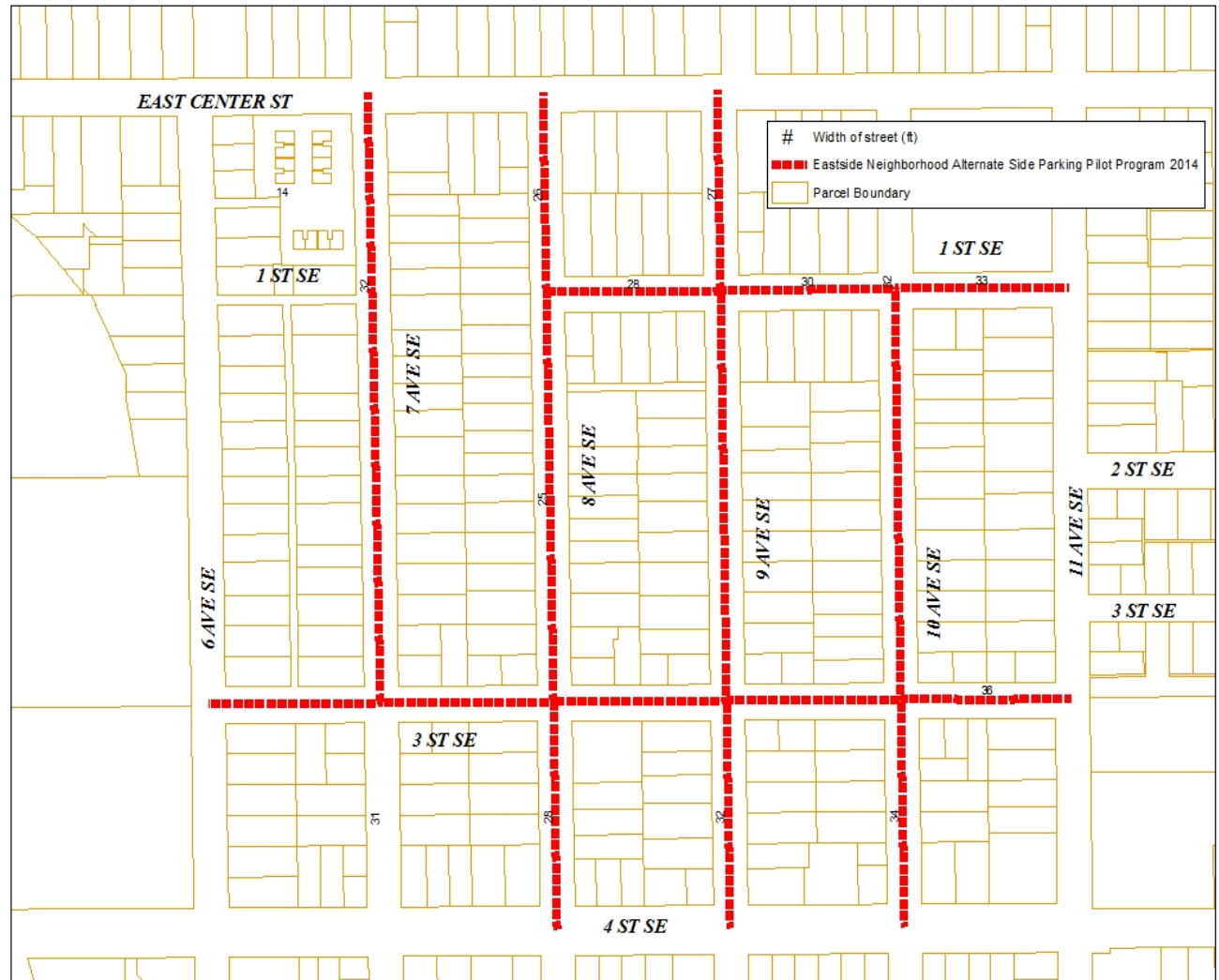

Streets that will follow the Winter Alternate Side Parking Pilot Program are identified within the neighborhood zone and are presented in **RED**.

The City of Rochester's Police and Public Works Departments have worked with neighborhood representatives to identify a neighborhood that is difficult to plow accumulated snow and or ice due to on-street parking. This portion of the Eastside Neighborhood has been designated an Alternate Side Winter Parking Zone. The neighborhood representatives elected to be involved in the program.

CITY OF ROCHESTER, MN - ALTERNATE SIDE WINTER PARKING - PILOT PROGRAM

ALTERNATE SIDE WINTER PARKING

The City has developed a Pilot Program to create Alternate Side Winter Parking Zones to enhance the effective removal of snow and ice during the winter. Alternate side parking regulations are proposed in order to reduce hazards and obstructions to the efficient movement of fire, police, emergency, and snow plows.

- A portion of the Eastside Neighborhood has been designated as an Alternate Side Winter Parking Zone due to the narrow streets and amount of on-street overnight parking.
- The parking ordinance is in effect **from December 1 to March 1, regardless of whether or not there is snow on the street.** People who park their vehicle on the street in a designated Alternate Side Winter Parking Zone must abide by the Alternate Side Parking Rules every day.
- From **8 a.m. to 5 p.m.** on odd numbered calendar dates, parking is only allowed on the odd numbered side of the street.
- From **8 a.m. to 5 p.m.** on even numbered calendar dates, parking is only allowed on the even numbered side of the street.
- Violations of the Alternative Side Parking rules are subject to a fine of \$22 and a towing fee.
- Parking is allowed on both sides of the street between 5 p.m. to 8 a.m., **except** where parking restrictions are posted.

QUESTIONS & ANSWERS

Q: Do I live in a Alternate Side Winter Parking Zone?

A: An Alternate Side Winter Parking Zone has been established in a portion of the Eastside Neighborhood. Signs are posted in the affected blocks.

Q: Where do I park my vehicle during the winter from December 1 to March 1?

A: Off-street parking is best. If off-street parking is not available, then park according to the Alternate Side Parking Rules.

Q: Will I get a ticket and will my vehicle be towed if I do not follow the Alternate Side Parking Rules?

A: Yes, however your vehicle will be towed only if it is a safety hazard. Alternate Side Parking Tickets and towing will begin on December 1.

Q: My vehicle was towed. Where is my vehicle?

A: Call the Rochester Police Department at [\(507\) 328-6800](tel:507-328-6800) to get the location of your vehicle.

Q: Where do I park on a street where parking is normally restricted to one side only?

A: Off-street parking is best. Alternate Side Parking Rules will not apply to your street. You must follow the existing posted parking restrictions that are in place at all times.

Q: What is the purpose of this pilot program?

A: The City Council wants to measure the pros and cons of the Program before implementing it on a larger scale. The Department wants your feedback on the Pilot Program, please contact Traffic & Parking Operations, Department of Public Works at (507) 328-2430 if you have questions.

ALTERNATE SIDE PARKING RULES

Don't let snow lead to a ticket or a tow. Here are a few things you need to know to **AVOID** a ticket or a tow:

- Alternate Side Parking takes effect from 8 a.m. until 5 p.m. every day during the winter period.
- Park on the **EVEN house** numbered side of the street on the **EVEN numbered dates** from 8 a.m. to 5 p.m. in the winter from December 1 to March 1.



EVEN Date

- Park on the **ODD house** numbered side of the street on the **ODD numbered dates** from 8 a.m. to 5 p.m. in the winter from December 1 to March 1.

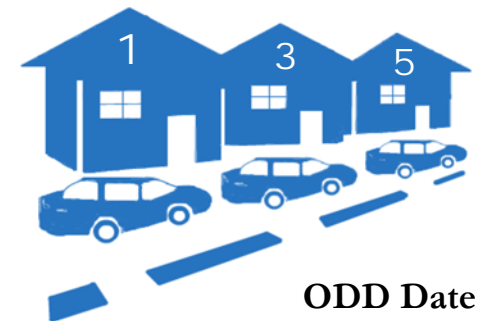

ODD Date